

**FX2-A3R / FX2-A3R-LED will be discontinued 9/24/2024**



[www.PanasonicSensors.com](http://www.PanasonicSensors.com)

### Features

- High-speed response (FX2-A3R)**  
 It has a high-speed response time of 15  $\mu$ s (in light receiving condition), and is suitable for detecting small objects or objects traveling at high-speed.  
 \* **FX2-A3R-LED** response time is 50 ms.
- LED sensing (FX2-A3R-LED)**  
 LED sensing type, which can detect weak lighting from LED, is also available.
- Multi-rotational adjuster**  
 The sensor has a multi-rotational adjuster for fine sensitivity adjustment. Moreover, the idling mechanism of the adjuster makes it free from damage due to over-turning.

Contact Ramco for our other 'high-speed' and 'LED sensing' solutions  
 Call (800) 280-6933 or email us at [nsales@ramcoi.com](mailto:nsales@ramcoi.com)

Lineup of high-speed response time:  
 15  $\mu$ s type (FX2-A3R) and LED sensing type (FX2-A3R-LED)

## ORDER GUIDE

### Amplifiers

Type	Appearance	Model No.	Response time (In light receiving condition)
For high-speed sensing		<b>FX2-A3R</b>	15 $\mu$ s or less
For LED sensing		<b>FX2-A3R-LED</b>	50 ms or less

### Fiber head

Type	Shape of fiber head	Sensing range [Min. sensing object in ( )]	Description	Fiber cable length	Model No.
Reflective type for high-speed sensing	Coaxial, Lens mountable M4 	4 mm 0.157 in ( $\phi$ 0.05 mm $\phi$ 0.002 in copper wire)	High-precision positioning thanks to a coaxial reflective type fiber	500 mm 19.685 in	<b>FD-G500</b>

### Accessories

- **FX-CT2** (Fiber cutter)
- **MS-FX-1** (Amplifier mounting bracket)

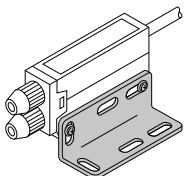

### FIBER SENSORS

#### LASER SENSORS

#### PHOTOELECTRIC SENSORS

#### MICRO PHOTOELECTRIC SENSORS

#### AREA SENSORS

#### SAFETY LIGHT CURTAINS / SAFETY COMPONENTS

#### PRESSURE / FLOW SENSORS

#### INDUCTIVE PROXIMITY SENSORS

#### PARTICULAR USE SENSORS

#### SENSOR OPTIONS

#### SIMPLE WIRE-SAVING UNITS

#### WIRE-SAVING SYSTEMS

#### MEASUREMENT SENSORS

#### STATIC CONTROL DEVICES

#### LASER MARKERS

#### PLC

#### HUMAN MACHINE INTERFACES

#### ENERGY MANAGEMENT SOLUTIONS

#### FA COMPONENTS

#### MACHINE VISION SYSTEMS

#### UV CURING SYSTEMS

#### Selection Guide

#### Fibers

#### Fiber Amplifiers

#### Other Products

#### FX-300

#### FX-311

#### FX-301-F7/ FX-301-F

#### FX-11A

#### FX2

#### FX-CH2

#### FX-CH