

Panasonic**INSTRUCTION
MANUAL**

Cable with Connector

CN-66A-C□

MJE-CN66AC No.0036-07V

Thank you very much for purchasing Panasonic products. Read this Instruction Manual carefully and thoroughly for the correct and optimum use of this product. Kindly keep this manual in a convenient place for quick reference.

1 OUTLINE

- This is a cable with a connector which can connect to the **DPC-100** series, etc.

2 SPECIFICATIONS

Type	2m type	5m type
Item Model No.	CN-66A-C2	CN-66A-C5
Cable	0.2mm ² 6-core cabtyre cable	
Cable length	2m	5m
Cable outer diameter	ø4.8mm	

3 PRECAUTIONS FOR CONNECTING / DISCONNECTING

- **Connecting**
 - Insert the connector into the connector area of the sensor till you hear a “click.”
 - **Disconnecting**
 - Pull out the connector, while depressing the release lever on the connector.
 - The force which can be applied to the cable is 10N or less.
- Do not pull by holding the cable, as this can result in cable disconnection.

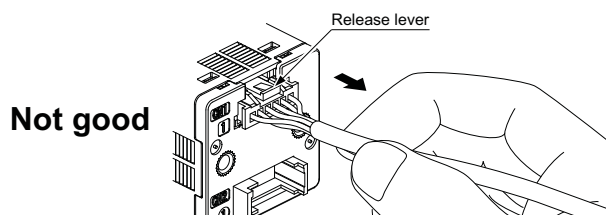

Wiring differs depending on a device to be connected. Refer to the Instruction Manual of the device to be connected for proper wiring.

Panasonic Industrial Devices SUNX Co., Ltd.<http://panasonic.net/id/pidsx/global>**Overseas Sales Division (Head Office)**

2431-1 Ushiyama-cho, Kasugai-shi, Aichi, 486-0901, Japan

Phone: +81-568-33-7861 FAX: +81-568-33-8591

About our sale network, please visit our website.

PRINTED IN JAPAN

© Panasonic Industrial Devices SUNX Co., Ltd. 2012