

342

Standard elongated hole, small type

BGS-S series,
BGS-2S series



Standard elongated hole type and small type BGS sensors

For locations with small mounting space

For accurate detection of small workpieces

High-speed response: 0.5 ms

BGS-S08 Style is Discontinued
All BGS-2S__Types are Discontinued

Related
products

C-MOS laser
**BGS-HL,
BGS-HDL**
● P.310



Laser type
BGS-ZL
● P.326



Stainless steel type
BGS-ZM
● P.334



Detection of electronic parts in trays

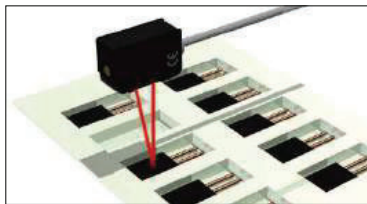

Detection of pills

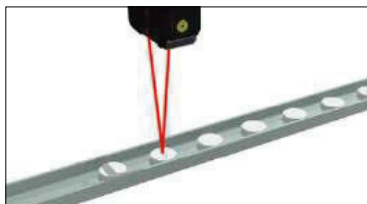

Detection of remaining parts on parts feeder

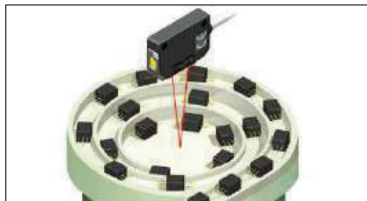

Detection of objects held by manipulator

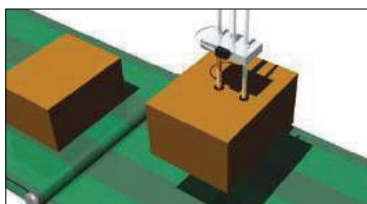

Selection table

Discontinued

Type	Shape	Sensing distance (Adjustable distance range shown in parentheses)	Model (Models in parentheses are connector types)	
			NPN type	PNP type
BGS		10 to 50 mm (10 to 30 mm)		BGS-S03P
		10 to 80 mm (10 to 80 mm)	BGS-S08N (BGS-S08CN)	BGS-S08P (BGS-S08CP)
		8 to 100 mm (20 to 100 mm)	BGS-2S10N	BGS-2S10P
		0 to 150 mm (50 to 150 mm)	BGS-2S15N (BGS-2S15CN)	BGS-2S15P (BGS-2S15CP)
		5 to 300 mm (25 to 300 mm)	BGS-2S30N (BGS-2S30CN)	BGS-2S30P (BGS-2S30CP)
		5 to 300 mm (25 to 300 mm)	BGS-2S30NT	BGS-2S30PT

● For the connector type, please purchase an optional JCN series connector cable.

Options/Accessories

Connector cables
Straight



JCN-S
Cable length: 2 m
JCN-5S
Cable length: 5 m
JCN-10S
Cable length: 10 m

L-shaped



JCN-L
Cable length: 2 m
JCN-5L
Cable length: 5 m
JCN-10L
Cable length: 10 m

Protective
mounting bracket
For BGS-S03□, -S08□

LS-S01



LS-S02



Sensor stand

Sensor stand
(Image is for flat surface mounting)

PLN-1
Reflector mounting bracket
for PLN-1

PLN-1M
PLN description
● P.242



For BGS-2S□□□

LS2-S01



OPTEX
FA

Ramco National - Optex FA Sensors

www.Optex-Ramco.com

Got Questions? 1-800-280-6933

Standard elongated hole, small type **BGS-S, BGS-2S** series**Can be safely used in locations with small mounting space****Small type**

BGS-S series is one of the smallest distance setting type photoelectric sensors. BGS sensors can now be used in locations where only small-sized diffuse-reflective type photoelectric sensors could be used up to now.

**Prevention of chattering****Type with timer functions**

The BGS-2S30NT is equipped with an OFF delay timer which can delay the time in which output is shut off by 0 to 100 ms. It is also effective when inputting to devices in which detecting signal slow.



OFF delay timer ►

For accurate detection of small workpieces**Small spot type (BGS-S03N)**

BGS-S03N is equipped a very small light spot which helps to detect small objects like electronic components. (at distance of 30 mm)

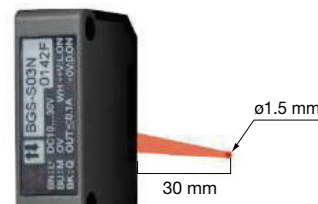
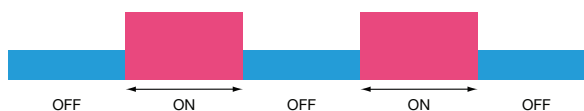
**Direct output****OFF delay output****High-speed response****0.5 ms high-speed response type**

This photoelectric sensor with built-in amplifier features a top level response time of 0.5 ms or less. This feature makes its use on high speed production lines possible.

**For accurate detection of substrates****Substrate detection type (BGS-2S10N)**

Features of this type include stable detection even if the substrate type is changed, as well as high repeat accuracy, even among models in the series.

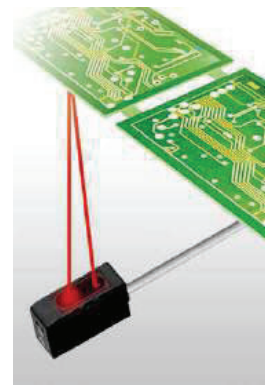
**Water resistant structure****Degree of protection on IP67**

All models in the BGS series conform to IP67 (protective resistance standard) and feature excellent dust and water resistance. It also conforms to CE standards and can be used in a wide range of locations.



Photoelectric Sensors

Specialized Photoelectric Sensors

Laser Displacement Sensors

BGS Sensors

BGS-HL,
BGS-HDL

BGS-DL

BGS-ZL,
BGS-Z

BGS-ZM

BGS-S,
BGS-2S

BGS

BGS-DL
(potentiometer type)

Photoelectric
SensorsSpecialized
Photoelectric
SensorsLaser
Displacement
Sensors

BGS Sensors

BGS-HL,
BGS-HDL

BGS-DL

BGS-ZL,
BGS-Z

BGS-ZM

BGS-S,
BGS-2S

BGS

BGS-DL
(potentiometer type)Standard elongated hole, small type **BGS-S, BGS-2S** series

Specifications

Type		Short-range (small spot)	Short-range
Model	NPN	Cable type	BGS-S03N
		Connector type	—
	PNP	Cable type	BGS-S03P
		Connector type	—
Sensing distance	White paper		10 to 50 mm
	Gray paper		8 to 30 mm
	Black paper		8 to 20 mm
Light source		Red LED	
Response time		0.5 ms or less	
Repeat accuracy		Light axis direction: 0.1 mm Vertical direction: 0.3 mm	Light axis direction: 0.2 mm Vertical direction: 0.2 mm
Hysteresis		10% or less	
Distance adjustment		5-turn endless potentiometer	
Indicators		Output indicator (orange), Stability indicator (green)	
Control output		NPN/PNP type open collector Max. 100 mA/30 VDC	
Output mode		Light ON / Dark ON switched by wiring	
Connection type		Cable type: Length 2 m (ø3.5 mm) / Connector type: M8, 4-pin	
Insulation resistance		20 MΩ or more (with 500 VDC)	
Rating	Supply voltage		10 to 30 VDC, including 10% ripple (p-p)
	Current consumption		20 mA or less
Applicable regulations		EMC directive (2004/108/EC)	
Applicable standards		EN 60947-5-2	
Company standards		Noise resistance: Feilen Level 4 cleared	
Environmental resistance	Ambient temperature/humidity		-25 to +55°C (no freezing) / 35 to 85% RH (no condensation)
	Ambient illuminance		Sunlight: 10,000 lx Incandescent lamp: 3,000 lx
	Vibration resistance		10 to 55 Hz; double amplitude 1.5 mm; 2 hours in each of the X, Y, and Z directions
	Shock resistance		Approx. 50 G (500 m/s ²), 3 times in each of the X, Y, and Z directions
Degree of protection		IEC standard, IP67	
Material		Housing: ABS (glass fiber filled, fire resistant), Front cover: Polycarbonate	
Weight without cable		Approx. 6 g	Approx. 9 g
Included accessories		Mounting bracket: BEF-W150-B	

● Specifications are subject to change without prior notice for product improvement purposes.

Type			Short-range	Mid-range	Mid-range	Mid-range (with timer function)
Model	NPN	Cable type	BGS-2S10N	BGS-2S15N	BGS-2S30N	BGS-2S30NT
		Connector type	—	BGS-2S15CN	BGS-2S30CN	—
	PNP	Cable type	BGS-2S10P	BGS-2S15P	BGS-2S30P	BGS-2S30PT
		Connector type	—	BGS-2S15CP	BGS-2S30CP	—
Sensing distance	White paper		3 to 100 mm	0 to 150 mm	5 to 300 mm	5 to 300 mm
	Gray paper		8 to 100 mm	25 to 150 mm	10 to 300 mm	10 to 300 mm
	Black paper		15 to 90 mm	25 to 80 mm	15 to 200 mm	15 to 200 mm
Light source			Red LED			
Response time			0.5 ms or less			
Repeat accuracy			Light axis direction: 0.1 mm Vertical direction: 0.3 mm		Light axis direction: 2.5 mm Vertical direction: 0.6 mm	
Hysteresis			10% or less			
Distance adjustment			6-turn endless potentiometer			5-turn endless potentiometer
Timer function			—			OFF delay timer 0 to 100 ms (variable)
Indicators			Output indicator (orange), Stability indicator (green)			
Control output			NPN/PNP type open collector Max. 100 mA/30 VDC			
Output mode			Light ON / Dark ON selectable			Light ON / Dark ON switched by wiring
Connection type			Cable type: Cable length: 2 m ø3.8 mm Connector type: M8, 4-pin			Cable type: Length: 2 m ø3.5 mm
Insulation resistance			20 MΩ or more (with 500 VDC)			
Rating	Supply voltage		10 to 30 VDC, including 10% ripple (p-p)			
	Current consumption		30 mA or less			20 mA or less
Applicable regulations			EMC directive (2004/108/EC)			
Applicable standards			EN 60947-5-2			
Company standards			Noise resistance: Feilen Level 3 cleared			Noise resistance: Feilen Level 4 cleared
Environmental resistance	Ambient temperature/humidity		-25 to +55°C (no freezing) / 35 to 85% RH (no condensation)			
	Ambient illuminance		Sunlight: 10,000 lx Incandescent lamp: 3,000 lx			
	Vibration resistance		10 to 55 Hz; double amplitude 1.5 mm; 2 hours in each of the X, Y, and Z directions			
	Shock resistance		Approx. 50 G (500 m/s²), 3 times in each of the X, Y, and Z directions			
	Degree of protection		IEC standard, IP67			
Material			Housing: ABS (glass fiber filled, fire resistant), Front cover: Polycarbonate			Housing: ABS (glass fiber filled, heat resistant) Front cover: Polycarbonate
Weight without cable			Approx. 6 g			Approx. 9 g
Included accessories			Mounting bracket: BEF-W140-B			

● Specifications are subject to change without prior notice for product improvement purposes.

Photoelectric
Sensors

Specialized
Photoelectric
Sensors

Laser
Displacement
Sensors

BGS Sensors

BGS-HL,
BGS-HDL

BGS-DL

BGS-ZL,
BGS-Z

BGS-ZM

BGS-S,
BGS-2S

BGS

BGS-DL
(potentiometer type)

Standard elongated hole, small type **BGS-S, BGS-2S** series

Distance adjustment

	Order	Diagram	Potentiometer	Light receiving indicator	Adjustment procedure
BGS	1			ON 	Set the object in the detection position and gradually raise the distance adjustment from the minimum to position A where the indicator will light up.
	2			OFF 	Remove the object and gradually lower the distance adjustment from the maximum to position B where the indicator will turn on.
	3			ON 	Position C between positions A and B is the optimal position for threshold. Positions A and B may be reversed depending on the model and the detection conditions. Place the workpiece in a fixed position and perform an operational check.

Photoelectric
SensorsSpecialized
Photoelectric
SensorsLaser
Displacement
Sensors

BGS Sensors

BGS-HL,
BGS-HDL

BGS-DL

BGS-ZL,
BGS-Z

BGS-ZM

BGS-S,
BGS-2S

BGS

BGS-DL
(potentiometer type)

I/O circuit diagram

■ NPN output type

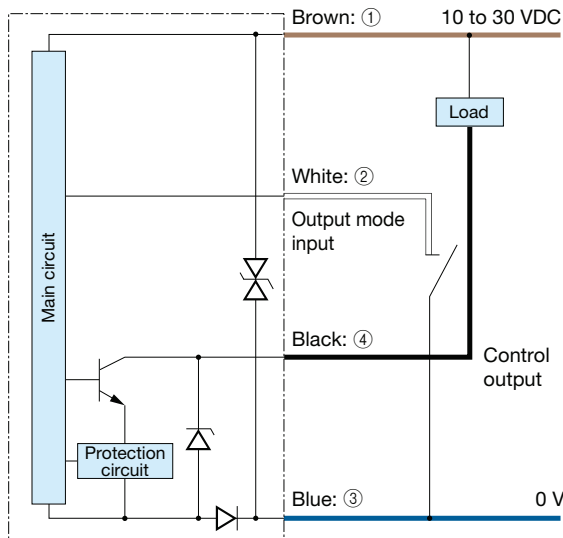

*White lead wire: ② is only equipped to BGS-S03□, -S08□, -2S30□T

■ PNP output type

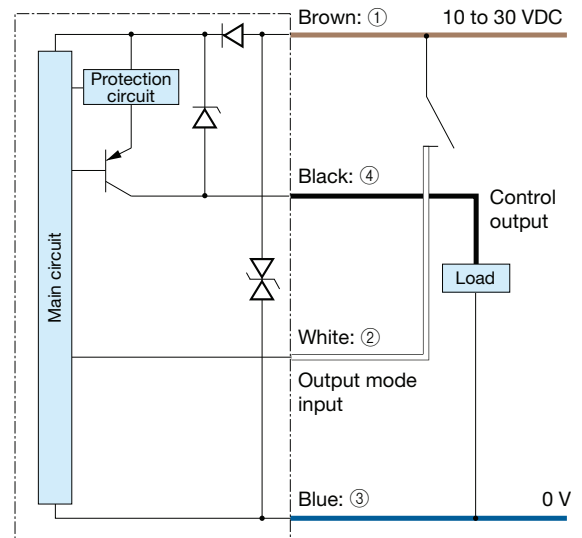

■ Connector type

(Pin configuration)

Sensor side Connector cable side



- ① 10 to 30 VDC
- ② Not connected/+V: Light ON (NPN)
0 V: Dark ON
- ③ 0 V
- ④ Control output

*Pin No. ② is not used for BGS-2S10□, -2S15□, -2S30□.

Connecting

- Turns to Light ON mode when the white wire is connected to +V or not connected and to Dark ON mode when connected to 0 V (for NPN). To use without connecting, disconnect and wrap individually with insulating tape, etc. Do not connect it to any other terminal.
- ① to ④ are connector pin No.

Notes

- When using a switching regulator for the power supply, be sure to ground the frame ground terminal.
- Avoid wiring in parallel with or in the same piping as high-voltage wires or power lines. Doing so may lead to malfunctions caused by noise. Also, shorten the power supply and signal wires as much as possible.
- Avoid using the transient state while the power is on (approx. 100 ms).
- The connector direction is fixed as in the drawing to the right when you use L-shaped connector cable. Be aware that rotation is not possible.

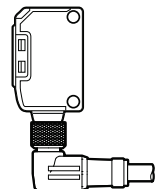

Dimensions

Sensor (BGS-S03□, -S08□)

(Unit: mm)

■ Cable type

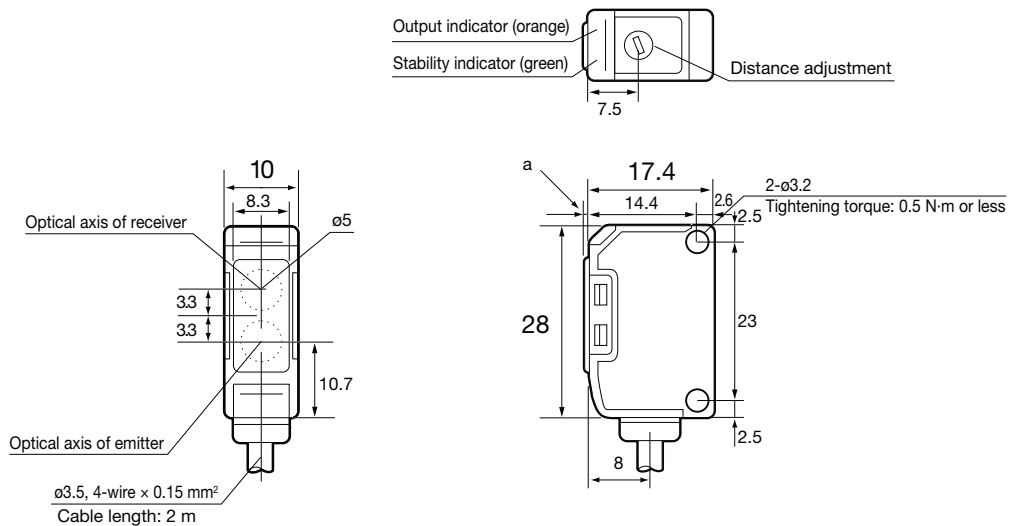

■ Connector type

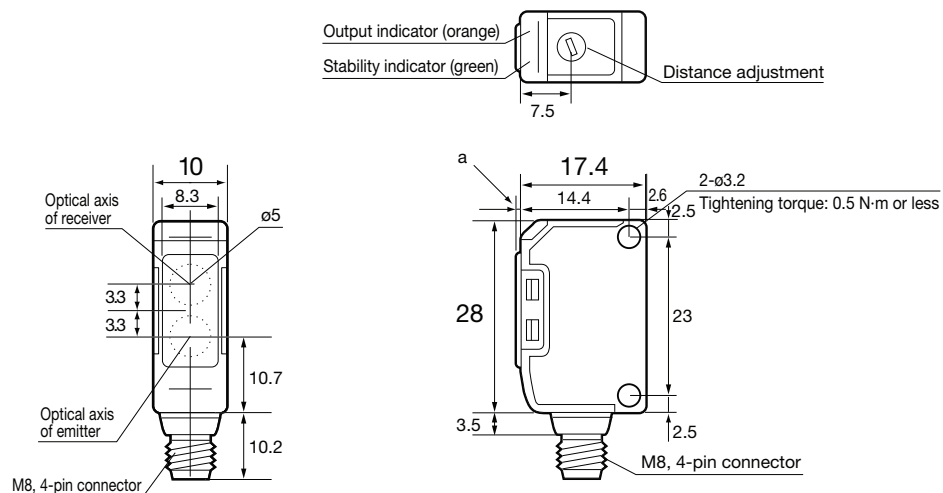

	BGS-S08□	BGS-S03□
a	1	2.4

348

Specialized
Photoelectric SensorsPhotoelectric
SensorsSpecialized
Photoelectric
SensorsLaser
Displacement
Sensors

BGS Sensors

BGS-HL,
BGS-HDL

BGS-DL

BGS-ZL,
BGS-Z

BGS-ZM

BGS-S,
BGS-2S

BGS

BGS-DL
(potentiometer type)Standard elongated hole, small type **BGS-S, BGS-2S** series

Dimensions

Mounting bracket (BGS-S03□, -S08□)

■ Cable type (when using included BEF-W150-B)

(Unit: mm)

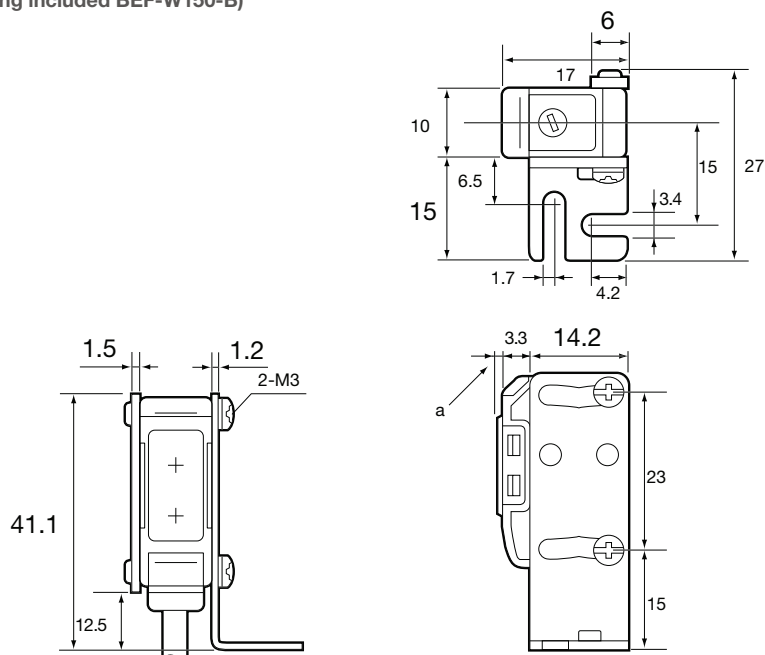

■ Connector type (when using optional BEF-W150-A)

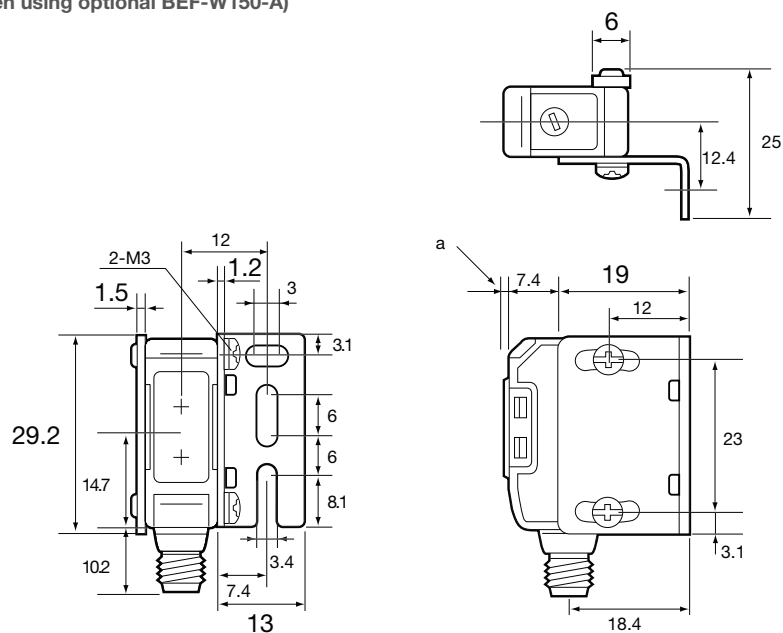

	BGS-S08□	BGS-S03□
a	1	2.4

OPTEX
FA

Ramco National - Optex FA Sensors

www.Optex-Ramco.com

Got Questions? 1-800-280-6933

Standard elongated hole, small type BGS-S, BGS-2S series

349

Specialized
Photoelectric Sensors

Sensor (BGS-2S□□□)

(Unit: mm)

■ Cable type

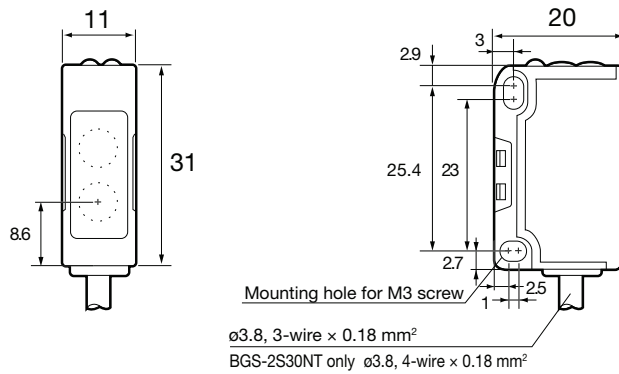
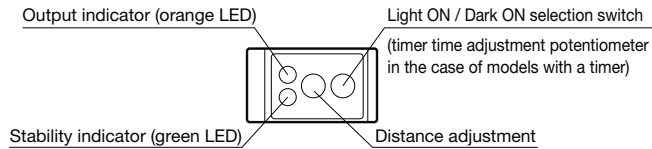

Mounting bracket (BGS-2S□□□)

■ Cable type
(when using included BEF-W140-B)

■ Connector type
(when using optional BEF-W140-A)

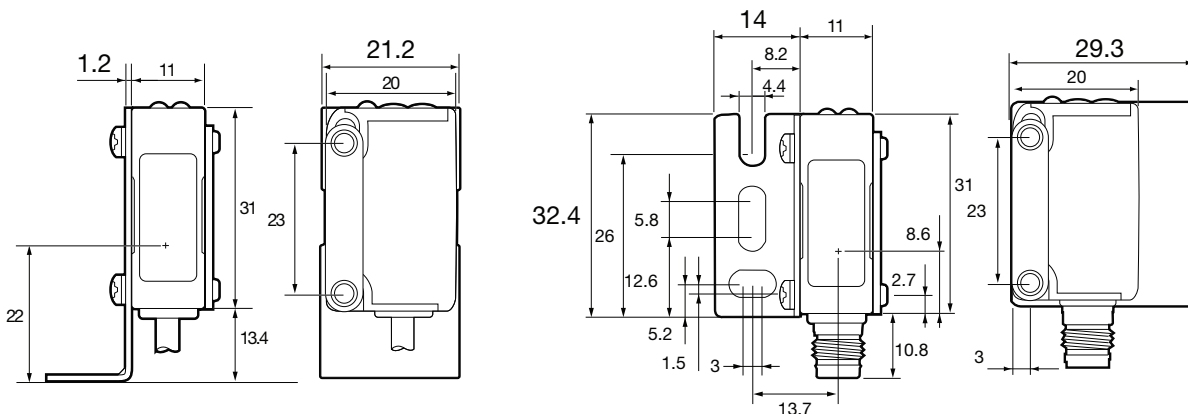
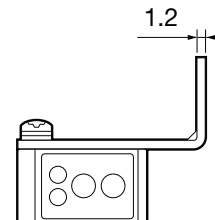
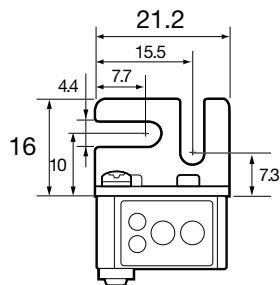

Photoelectric
Sensors

Specialized
Photoelectric
Sensors

Laser
Displacement
Sensors

BGS Sensors

BGS-HL,
BGS-HDL

BGS-DL

BGS-ZL,
BGS-Z

BGS-ZM

BGS-S,
BGS-2S

BGS

BGS-DL
(potentiometer type)

350

Specialized Photoelectric Sensors

Photoelectric
Sensors

Specialized
Photoelectric
Sensors

Laser
Displacement
Sensors

BGS Sensors

BGS-HL,
BGS-HDL

BGS-DL

BGS-ZL,
BGS-Z

BGS-ZM

BGS-S,
BGS-2S

BGS

BGS-DL
(potentiometer type)

Standard elongated hole, small type **BGS-S, BGS-2S** series

Dimensions

Connector cable (optional)

■ JCN-S, JCN-5S, JCN-10S

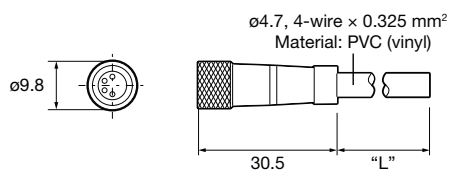

■ JCN-L, JCN-5L, JCN-10L

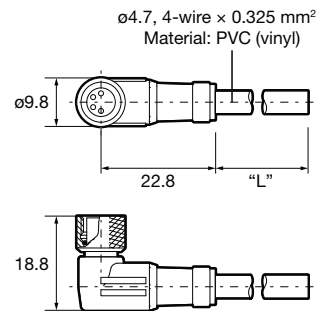

(Unit: mm)

OPTEX
FA

Ramco National - Optex FA Sensors

www.Optex-Ramco.com

Got Questions? 1-800-280-6933

Typical characteristic data

* Please contact a sales representative for any other characteristic data that may be required.

BGS-S03□, BGS-S08□

— BGS-S03□ — BGS-S08□

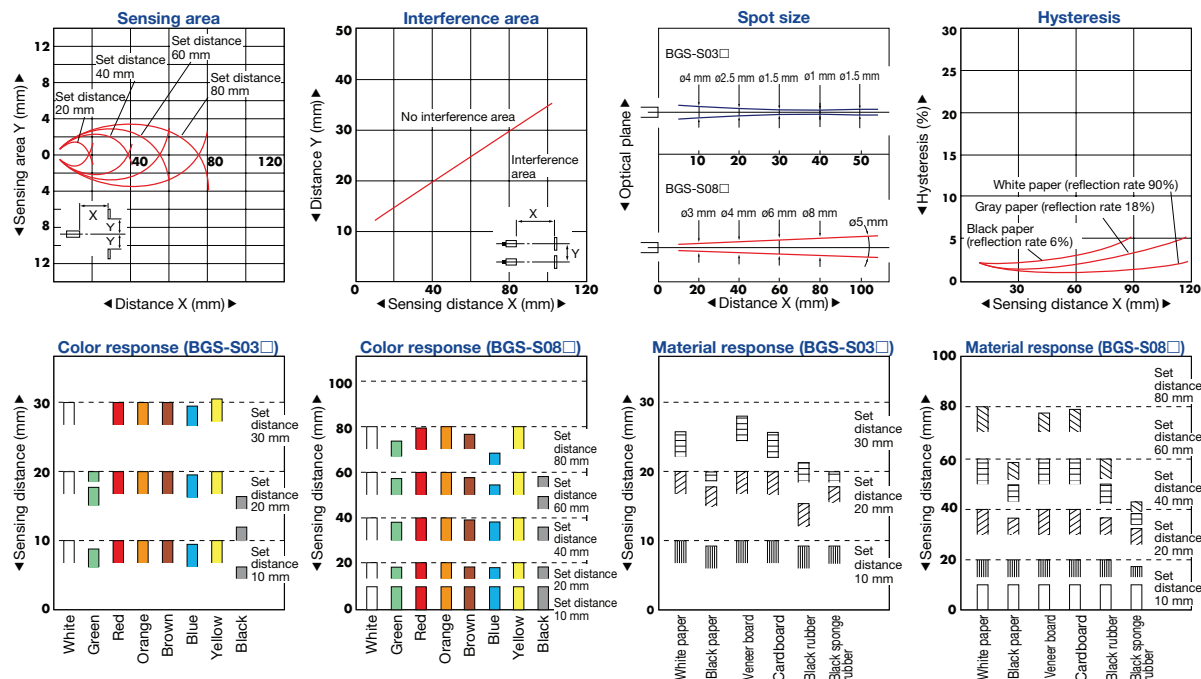

BGS-2S15□, BGS-2S30□

— BGS-2S15□ — BGS-2S30□

